

TILTA CAMERA RIG FOR

FUJIFILM

X-T3

CAGE HANDLES SUPPORT SYSTEM ACCESSORIES

Universal hand strap

(Included)

Hand strap can be adjusted to fit your hand.

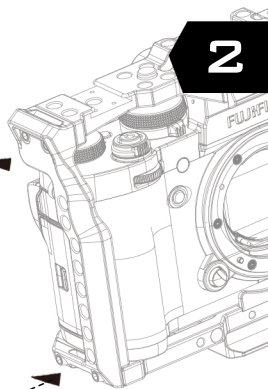
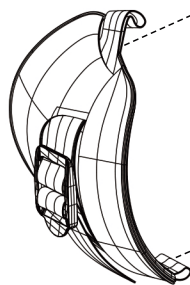

2

1

Install the X-T3 camera into the cage

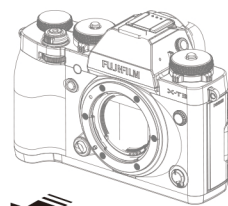
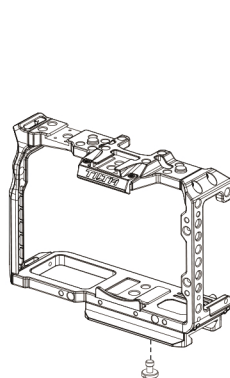

Mount the camera in the correct position and then insert and tighten the mounting screw

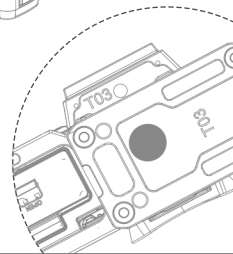

3

A limit stop is located on the cold shoe mount in the front of the top handle

Slide the top handle into the cold shoe mount and then fasten the knob (Optional)

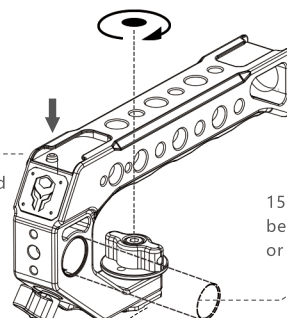

15mm rod adapter can be used to mount EVFs or other accessories

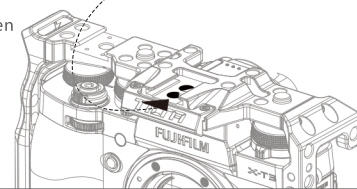

Note: Please select the correct quick release plate for your camera. Only one quick release plate is included in the package.

Quick release plate (Included)

Arca standard plate (Optional)

Manfrotto standard plate (Optional)

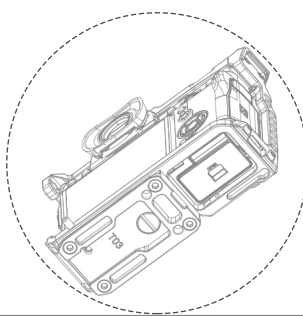
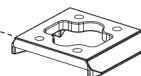
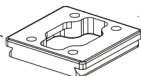
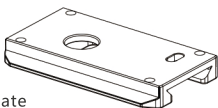

4

5

Base single rod adaptor TA-BSRA-15-G (Optional)

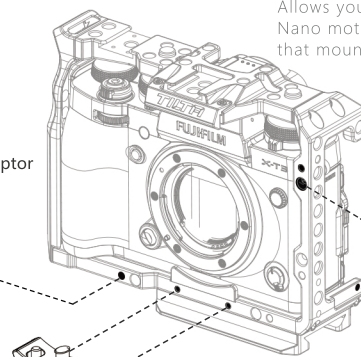

Lens support (Optional)

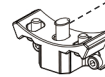

HDMI and handle R/S cable mount (Included)

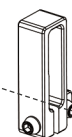

Slide the camera onto the baseplate until the stopper is bounced back, then fasten the lever (Optional)

For 15mm LWS rods

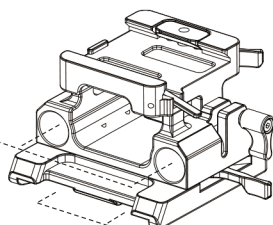

Tilta standard dovetail spacing

6

7

Side handle (Optional)

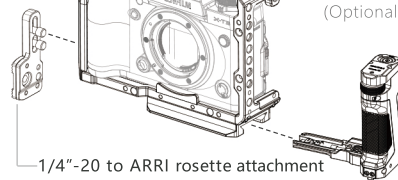

1/4"-20 to ARRI rosette attachment The function is shown below

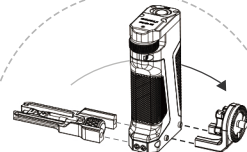

Note: The correct attachment needs to be fastened depending on which side of the cage the handle will be attached.

1/4"-20 to ARRI rosette attachment (Optional)

This Universal converter is compatible with handles that have ARRI rosettes. This allows the handles to be mounted on the left or right side of the cage.

