

Z-CAM

E2-S6

CAGE TOP HANDLE BASEPLATE ACCESSORIES

1

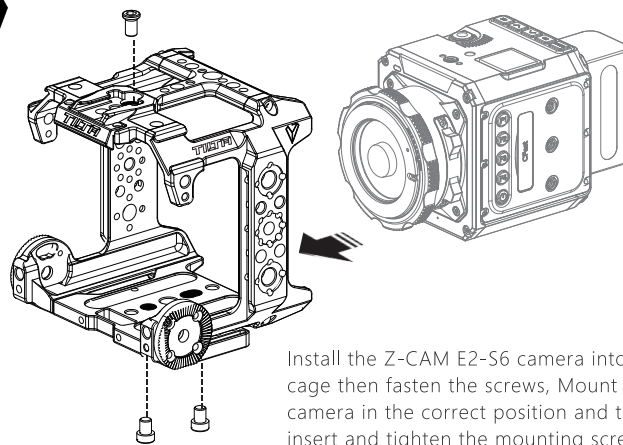

Install the Z-CAM E2-S6 camera into the cage then fasten the screws, Mount the camera in the correct position and then, insert and tighten the mounting screw.

2

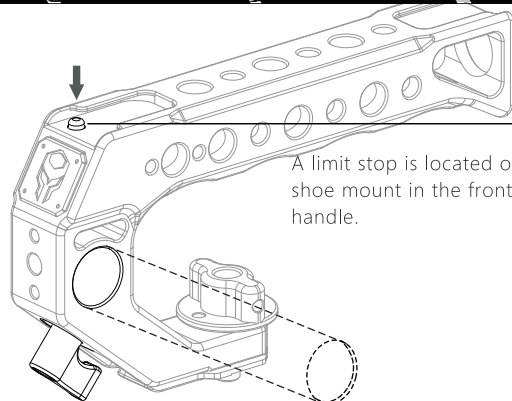

A limit stop is located on the cold shoe mount in the front of the top handle.

15mm rod adapter can be used to mount EVFs or other accessories.

3

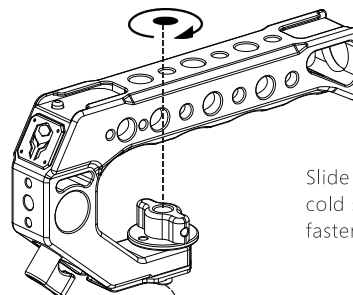

Slide the top handle into the cold shoe mount and then fasten the knob(Optional).

Top handle is compatible with all Tilting cages.

4

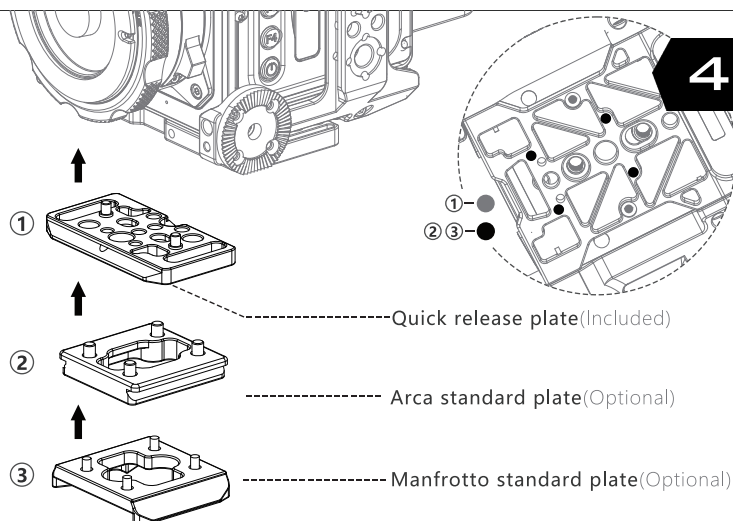

Quick release plate(Included)

Arca standard plate(Optional)

Manfrotto standard plate(Optional)

5

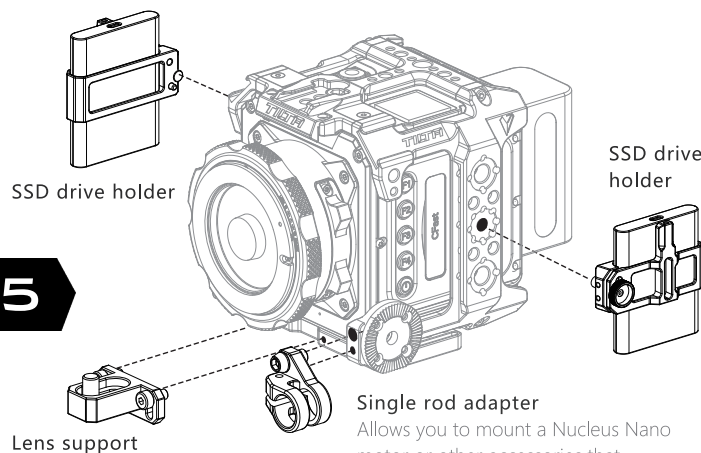

SSD drive holder

SSD drive holder

Lens support

Single rod adapter
Allows you to mount a Nucleus Nano motor or other accessories that mount onto a single 15mm rod.

6

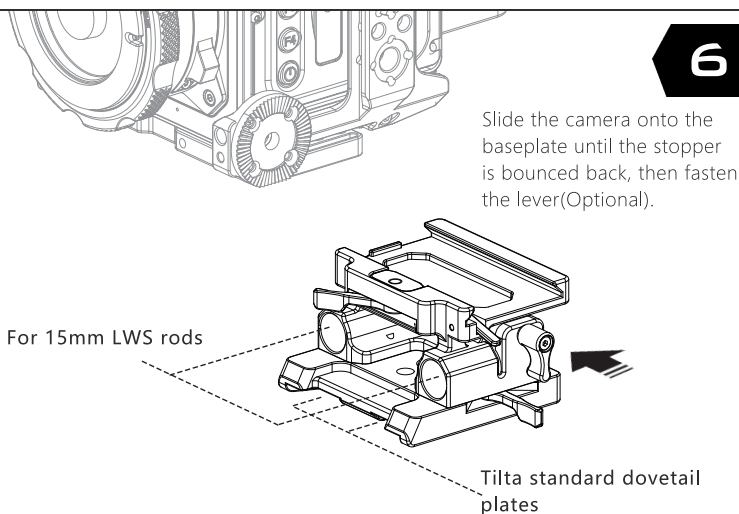

Slide the camera onto the baseplate until the stopper is bounced back, then fasten the lever(Optional).

For 15mm LWS rods

Tilta standard dovetail plates

7

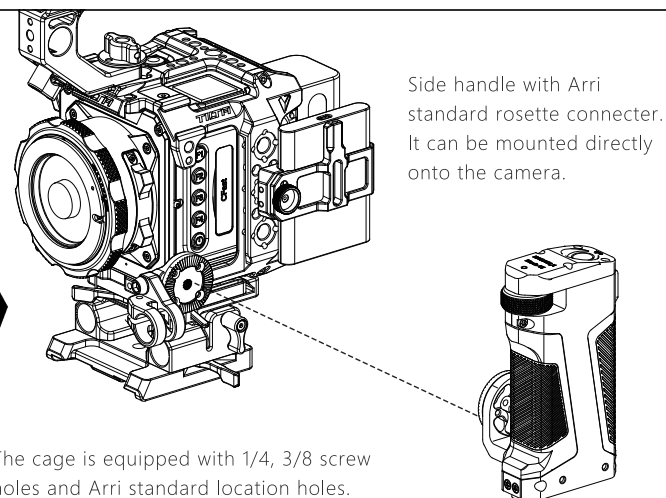

Side handle with Arri standard rosette connector. It can be mounted directly onto the camera.

The cage is equipped with 1/4, 3/8 screw holes and Arri standard location holes.

8

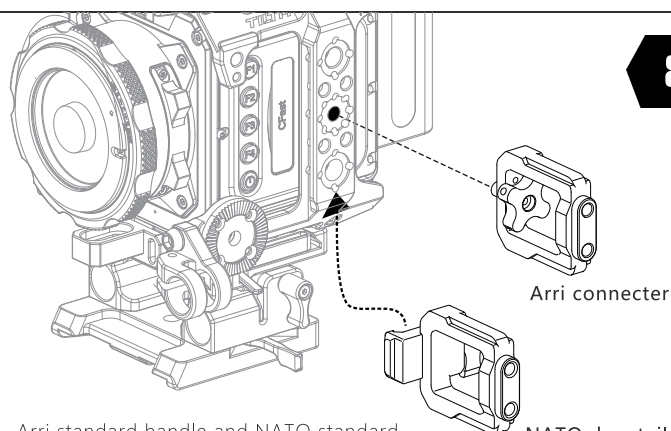

Arri connector

NATO dovetail connector

Arri standard handle and NATO standard handle can both be mounted on the side of the cage.

9

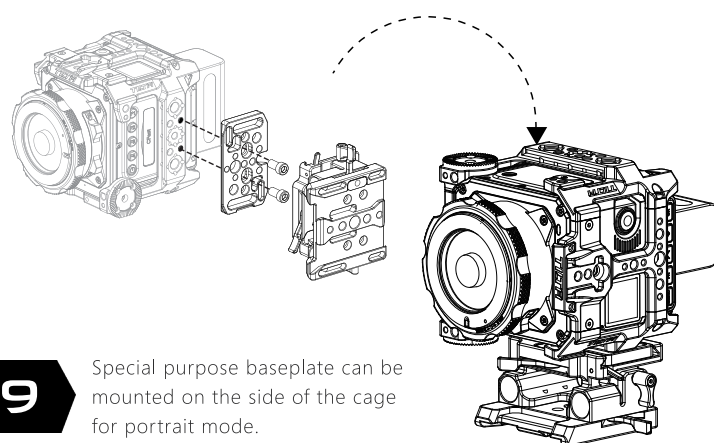

Special purpose baseplate can be mounted on the side of the cage for portrait mode.