

# BASIC RING GRIP PLUS FOR DJI RONIN

————>>>>  
DJI RONIN环形手持简易套装

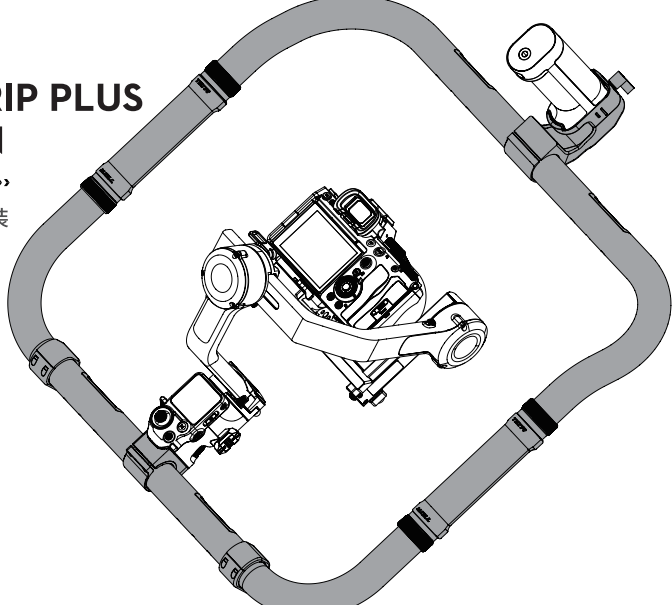

**TILTA**

## **DISCLAIMER**

»»

Thank you for purchasing TILTA products.

Before using this product, please carefully read this document to ensure that the product has been set up correctly. The final interpretation of this document and all related documents for this product belongs to TILTA. For updates, please visit the official website at [www.tilta.com](http://www.tilta.com) for the latest product information.

TILTA reserves the right to modify any information in this manual at any time without prior notice and without assuming any responsibility.

By using this product, you are deemed to have carefully read the disclaimer and warnings, understood, agreed, and accepted all the terms and content of this statement. You promise to take full responsibility for the use of this product and any consequences that may arise. You commit to using this product only for legitimate purposes and agree to these terms as well as any related regulations, policies, and guidelines set by TILTA.

TILTA is not responsible for any damages, injuries, or legal liabilities caused directly or indirectly by the use of this product. Users should follow all safety guidelines mentioned in this document, including but not limited to those mentioned.

Despite the above provisions, consumer rights are still protected by local laws and regulations are not affected by this disclaimer.

TILTA is a trademark of Shenzhen TILTA Technology Co., Ltd. and its affiliated companies. Product names, brands, and other trademarks appearing in this document are trademarks or registered trademarks of their respective companies.

## IN THE BOX

»»

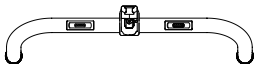

---

Ring Grip - Top Arm

×1

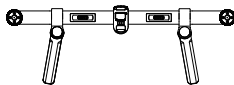

---

Ring Grip - Bottom Arm

×1

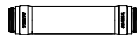

---

I-Shaped Grip

×2

# INTRODUCING BASIC RING GRIP PLUS FOR DJI RONIN

Compatible with DJI RS 2/RS 3/RS 3 Pro/RS 4/RS 4 Pro Gimbals

- 01 Power Supply Handle Attachment
- 02 Power Port
- 03 Ring Grip - Top Arm
- 04 Tie Down Ring
- 05 I-Shaped Grip
- 06 Gimbal Mounting Base
- 07 Battery Grip Locking Knob
- 08 Cold Shoe
- 09 Ring Grip - Bottom Arm
- 10 Foot Release
- 11 Foot

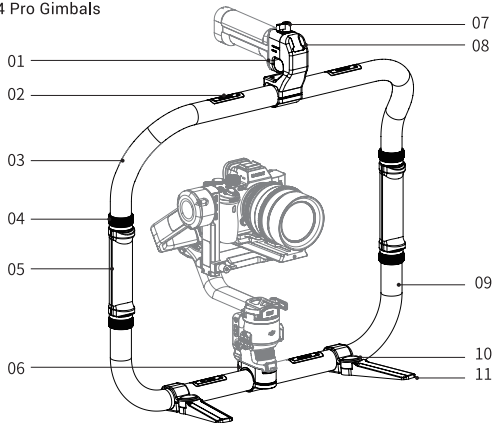



## ASSEMBLING



(1) Press down the foot release buttons and turn the feet outwards.

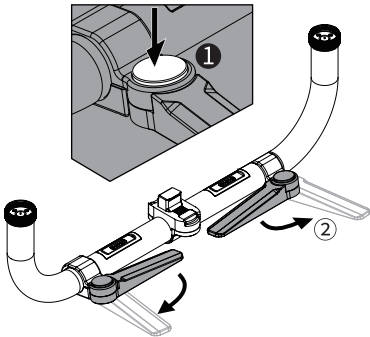

(2) Align the locating pins and attach the I-Shaped Grips to the lower arm interfaces of the ring grip. Rotate the knobs counterclockwise to lock them in place.

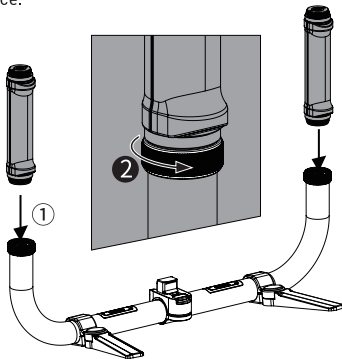

(3) Install the ring grip's upper arm above the two I-Shaped Grips and rotate the knobs clockwise to secure them.

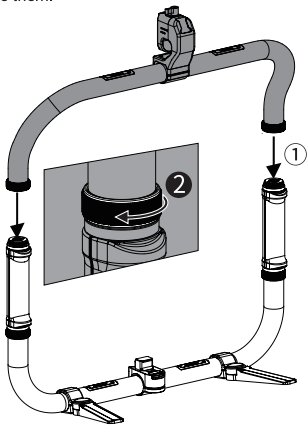

(4) Attach DJI RS 2/RS 3/RS 3 PRO/RS 4/RS 4 PRO to the ring grip.

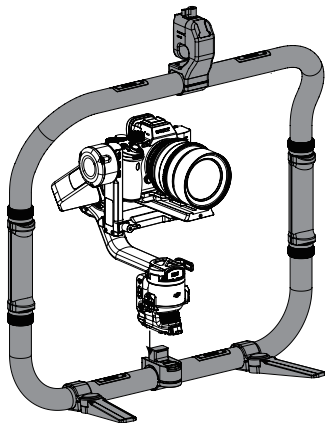

(5) Insert DJI RS 2/RS 3/RS 3 PRO/RS 4/RS 4 PRO battery grip into the power supply handle attachment and tighten the tie down.

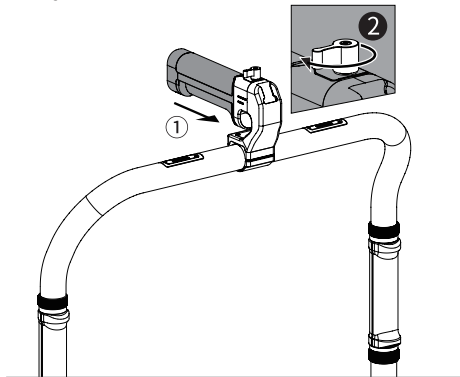

(6) The basic ring grip setup is complete.

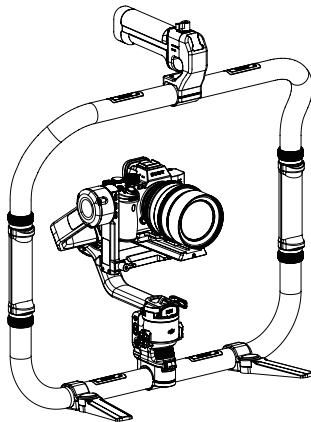

## OPTIONAL

### Power Supply Module for Ring Grip (TGA-RG-PM)

Attach the power supply module to the power port on the top arm. Tighten with the screws.

The built-in cold shoe, 1/4"-20, and 3/8"-16 screw points are compatible with monitor mount, phone mount, etc. The 14.8V P-tap port and USB port can power on-board monitor and phone.

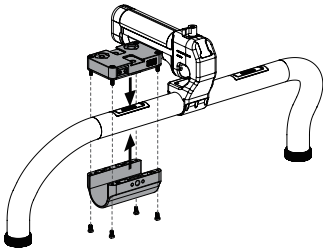

### V-Mount Battery Plate for Ring Grip (TGA-RG-V)/ Gold Mount Battery Plate for Ring Grip (TGA-RG-AB)

V-mount or gold mount battery plate can be installed to power port on the bottom arm. Tighten with the screws. Used to supply uninterrupted electric power.

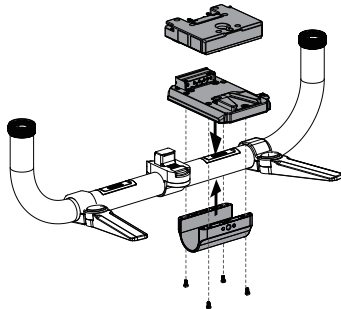

## 免责声明

---

感谢您购买TILTA的产品。

使用本产品之前,请仔细阅读本文以确保已对产品进行正确的设置。本文档及本产品所有相关的文档最终解释权归TILTA所有。如有更新,请访问WWW.TILTA.COM官方网站

获取最新的产品信息。TILTA保留随时修改本手册中任何信息的权利,无需提前通知且不承担任何责任。

一旦使用本产品,即视为您已经仔细阅读免责声明与警告,理解、认可和接受本声明全部条款和内容。您承诺对使用本产品以及可能带来的后果负全部责任。

您承诺仅出于正当目的使用本产品,并且同意本条款以及TILTA制定的任何相关条例、政策和指引。

TILTA对于直接或间接使用本产品而造成的损坏、伤害以及任何法律责任不予负责。用户应遵循包括但不限于本文提及的所有安全指引。

即使存在上述规定,消费者权益依然受当地法律法规所保障,并不受本免责声明影响。

TILTA是深圳市铁头科技有限公司及其关联公司的商标。本文出现的产品名称、品牌等均为其所属公司的商标或注册商标。

## 物品清单

»»

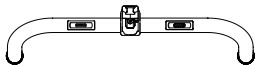

环形手持-上臂

×1

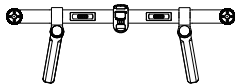

环形手持-下臂

×1

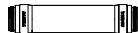

工型握把

×2

## 认识环形手持简易套装

适配DJI RS 2/RS 3/RS 3 PRO/RS 4/RS 4 PRO云台

- 01 供电手柄接驳件
- 02 供电接口
- 03 环形手持-上臂
- 04 旋钮
- 05 工型握把
- 06 云台安装底座
- 07 供电手柄锁紧旋钮
- 08 冷靴槽
- 09 环形手持-下臂
- 10 脚架开关
- 11 脚架

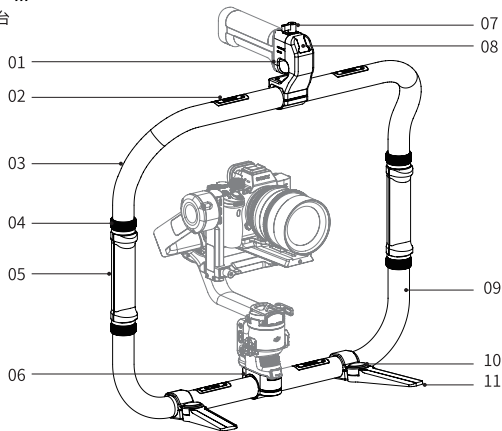

## 安 装

(1) 按下圆形脚架开关，分别向外侧打开脚架。

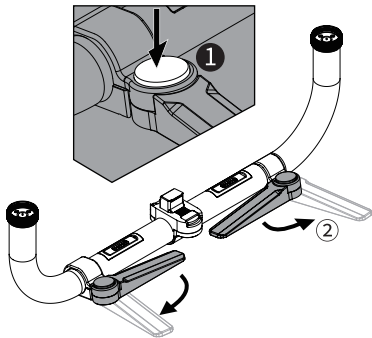

(2) 对准限位柱，将工型握把安装至环形手持-下臂的手柄接口上，逆时针方向转动旋钮，锁紧握把。

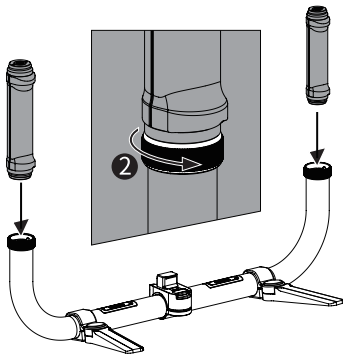



(3) 将环形手持-上臂安装至两个工型握把的上方，  
顺时针方向转动旋钮锁紧。

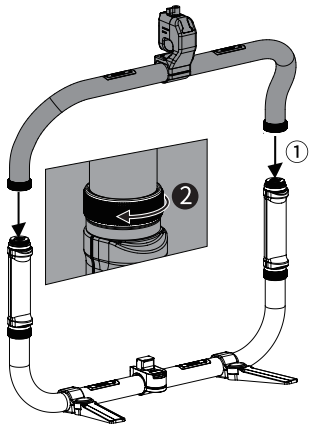

(4) 将DJI RS 2/RS 3/RS 3 PRO/RS 4/RS 4 PRO  
安装至环形手持上。

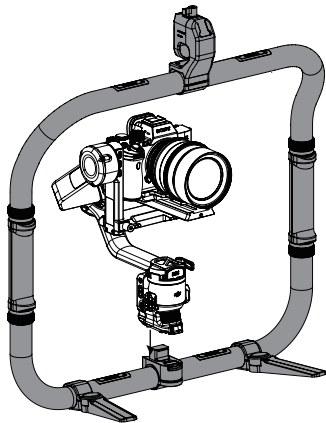

(5) 将DJI RS 2/RS 3/RS 3 PRO/RS 4/RS 4 PRO电池手柄安装进供电手柄接驳件中, 锁紧旋钮。

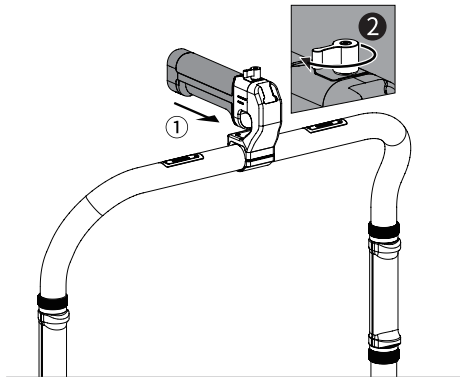

(6) 安装完成。

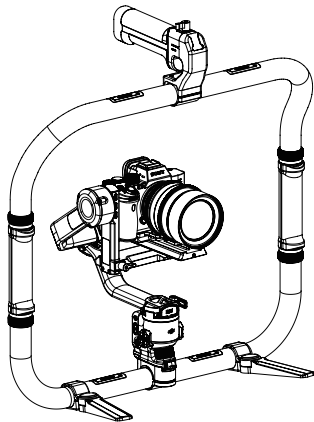

## 选 配

### 环形手持输出供电 (TGA-RG-PM)

可将输出供电安装至上环臂供电口位置处，螺丝锁紧即可。

有预留冷靴口、1/4、3/8螺纹口，可以接蜗4云台，手机支架等配件。  
有14.8VD-TAP供电和USB供电接口，可以给监视器和手机供电。

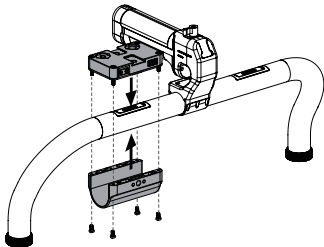

### V口供电底座 (TGA-RG-V) / 安东口供电底座 (TGA-RG-AB)

可将V口供电底座或安东口供电底座安装至上环臂供电口位置处，螺丝锁紧即可。可实现超续航不间断供电。

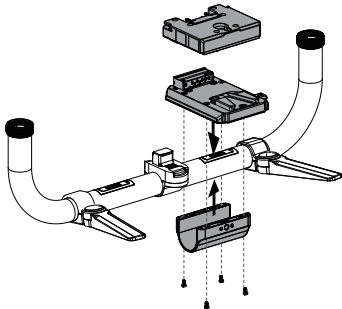

**BASIC RING GRIP PLUS FOR DJI RONIN**