

BASIC RING GRIP PLUS FOR DJI RONIN CONTROL KIT

DJI RONIN环形手持控制套装

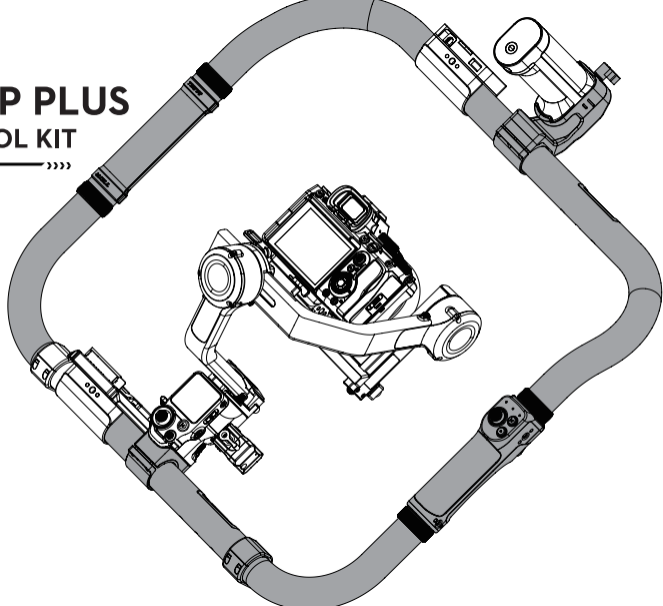

TILTA

DISCLAIMER

Thank you for purchasing TILTA products.

Before using this product, please carefully read this document to ensure that the product has been set up correctly. The final interpretation of this document and all related documents for this product belongs to TILTA. For updates, please visit the official website at www.tilta.com for the latest product information.

TILTA reserves the right to modify any information in this manual at any time without prior notice and without assuming any responsibility.

By using this product, you are deemed to have carefully read the disclaimer and warnings, understood, agreed, and accepted all the terms and content of this statement. You promise to take full responsibility for the use of this product and any consequences that may arise. You commit to using this product only for legitimate purposes and agree to these terms as well as any related regulations, policies, and guidelines set by TILTA.

TILTA is not responsible for any damages, injuries, or legal liabilities caused directly or indirectly by the use of this product. Users should follow all safety guidelines mentioned in this document, including but not limited to those mentioned.

Despite the above provisions, consumer rights are still protected by local laws and regulations are not affected by this disclaimer.

TILTA is a trademark of Shenzhen TILTA Technology Co., Ltd. and its affiliated companies. Product names, brands, and other trademarks appearing in this document are trademarks or registered trademarks of their respective companies.

IN THE BOX

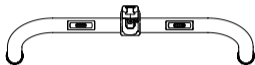

Ring Grip - Top Arm

×1

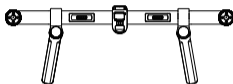

Ring Grip - Bottom Arm

×1



I-Shaped Grip

×1



Wireless Control
Receiver Module for RS 2

×1



Remote Control Handle for
Basic Ring Grip Plus

×1

Protective Cover

×2

INTRODUCING BASIC RING GRIP PLUS FOR DJI RONIN CONTROL KIT

Compatible with DJI RS 2/RS 3 Pro/RS 4/RS 4 Pro Gimbals

- 01 Power Supply Handle Attachment
- 02 Power Port
- 03 Ring Grip - Top Arm
- 04 Tie Down Ring
- 05 Remote Control Handle for Basic Ring Grip Plus
- 06 Wireless Control Receiver Module for RS 2
- 07 Gimbal Mounting Base
- 08 Foot Release
- 09 Foot
- 10 Battery Grip Locking Knob
- 11 Cold Shoe
- 12 Power Supply Module (optional)
- 13 I-Shaped Grip
- 14 Ring Grip - Bottom Arm
- 15 V-Mount Battery Plate (optional)

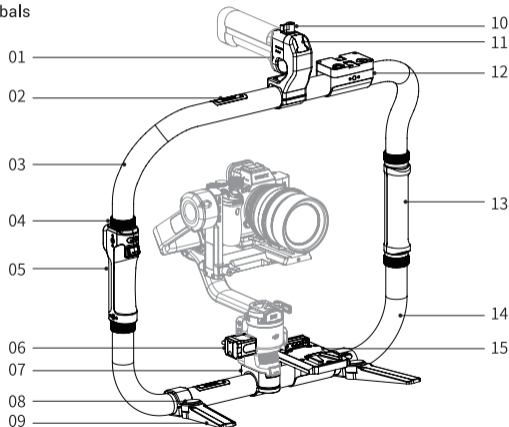

INTRODUCING THE REMOTE CONTROL HANDLE FOR BASIC RING GRIP PLUS

>>>

- 01 1/4"-20 Thread with Locating Points
- 02 Joystick
- 03 1/4"-20 Thread with Locating Points
- 04 Indicator Lights
- 05 M Key
- 06 Camera Control
- 07 1/4"-20 Thread with Locating Points
- 08 1/4"-20 Thread with Locating Points
- 09 Protective Cover
- 10 USB-C Port
- 11 Trigger

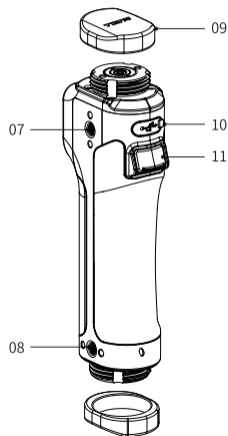
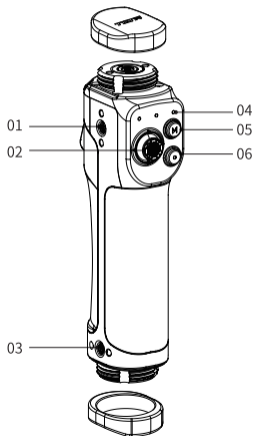

REMOTE HANDLE BUTTON FUNCTIONS

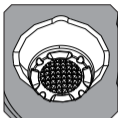

JOYSTICK

Up & down: Control tilt (default setting)

Left & right: Control pan (default setting)

Calibration Method: (1) Press the trigger button three times consecutively, then press and hold on the fourth press. The three indicator lights will blink. Move the joystick up, down, left, and right in a full circle, then wait 10 seconds for the lights to return to normal.

(2) If calibration fails, the lights will turn red. Press the trigger three times again and hold on the fourth press to exit calibration, then recalibrate.



M KEY

Single click: Switching Gimbal Modes. Indicator lights turn green and change for each mode.

(Three modes: M1 - FPV Mode; M2 - Pan Follow; M3 - Pan and Tilt Follow)

Double click: Vertical mode. Double click again to exit the vertical mode.

Triple click: 360 mode. Repeat triple click to exit 360 mode. Under 360 mode, pressing the joy stick twice either left or right will make the camera spin automatically. Double click trigger to stop this action.

Hold: Activates Sport Mode (release the M button to exit).

Hold + Double-Click Trigger: Locks Sport Mode (no need to keep holding). Repeat the operation to exit the function.

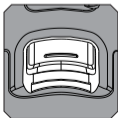

TRIGGER

Single click: Start smart following (wireless video system not activated)

Double click: Reset gimbal

Triple click: Selfie mode

Hold: Lock mode

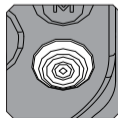

CAMERA CONTROL

Half way hold: Auto focus control

Quick click: Start/stop recording

Long hold: Take photos

ASSEMBLING

(1) Press down the foot release buttons and turn the feet outwards.

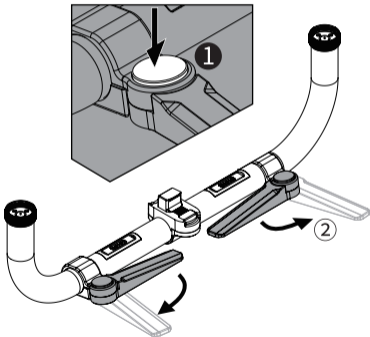

(2) Align the locating pins and attach both handles to the lower arm interfaces of the ring grip. Rotate the knobs counterclockwise to lock them in place.

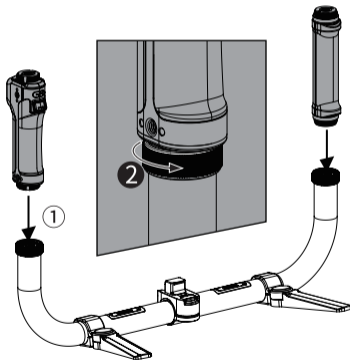

(3) Install the ring grip's upper arm above the two handles and rotate the knobs clockwise to secure them.

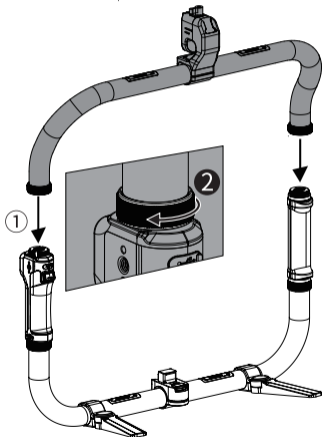

(4) Attach DJI RS 2/RS 3 PRO/ RS 4/RS 4 PRO to the ring grip.

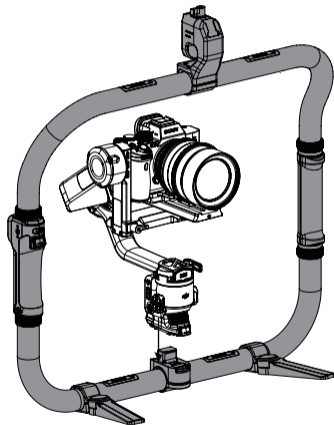

(5) Attach the wireless control receiver module to the NATO rail on the right side of DJI RS 2/RS 3 PRO/RS 4/RS 4 PRO. Tighten the tie down.

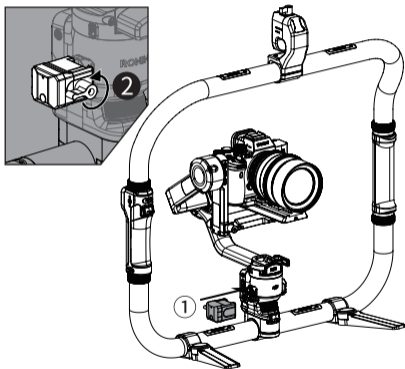

(6) Insert DJI RS 2/RS 3 PRO/RS 4/RS 4 PRO battery grip into the power supply handle attachment and tighten the tie down.

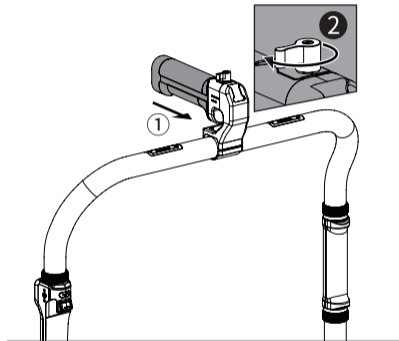

(7) Assembly is now complete. Once the ring grip is powered on, the installed remote handle and wireless receiver will turn on simultaneously, with green indicator lights illuminated.

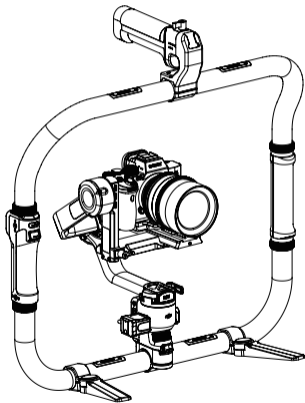

REMOTE HANDLE & WIRELESS RECEIVER PAIRING

- (1) Double-click the button on the wireless receiver—the red light will flash when waiting to pair with the remote handle.
- (2) On the remote handle, hold both the [Camera Control Button] and the [M Button] to enter auto-pairing mode. Indicator lights will cycle; when they stop and turn green, pairing is successful. If red, pairing failed—retry.

WIRELESS CHANNEL SWITCHING

Hold both the [Camera Control Button] and the [Trigger Button] on the remote handle. Blinking lights indicate the wireless channel has been switched.

OPTIONAL >>>

Power Supply Module for Ring Grip (TGA-RG-PM)

Attach the power supply module to the power port on the top arm. Tighten with the screws.

The built-in cold shoe, 1/4"-20, and 3/8"-16 screw points are compatible with monitor mount, phone mount, etc. The 14.8V P-tap port and USB port can power on-board monitor and phone.

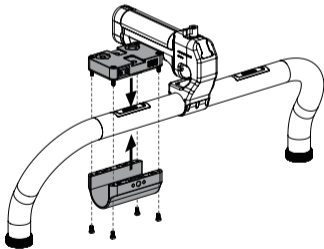

V-Mount Battery Plate for Ring Grip (TGA-RG-V)/ Gold Mount Battery Plate for Ring Grip (TGA-RG-AB)

V-mount or gold mount battery plate can be installed to power port on the bottom arm. Tighten with the screws. Used to supply uninterrupted electric power.

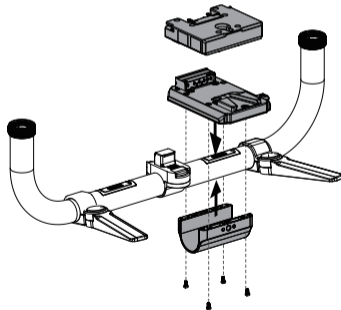

免责声明

感谢您购买TILTA的产品。

使用本产品之前,请仔细阅读本文以确保已对产品进行正确的设置。本文档及本产品所有相关的文档最终解释权归TILTA所有。如有更新,请访问WWW.TILTA.COM官方网站

获取最新的产品信息。TILTA保留随时修改本手册中任何信息的权利,无需提前通知且不承担任何责任。

一旦使用本产品,即视为您已经仔细阅读免责声明与警告,理解、认可和接受本声明全部条款和内容。您承诺对使用本产品以及可能带来的后果负全部责任。

您承诺仅出于正当目的使用本产品,并且同意本条款以及TILTA制定的任何相关条例、政策和指引。

TILTA对于直接或间接使用本产品而造成的损坏、伤害以及任何法律责任不予负责。用户应遵循包括但不限于本文提及的所有安全指引。

即使存在上述规定,消费者权益依然受当地法律法规所保障,并不受本免责声明影响。

TILTA是深圳市铁头科技有限公司及其关联公司的商标。本文出现的产品名称、品牌等均为其所属公司的商标或注册商标。

物品清单

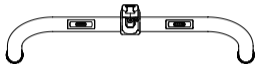

环形手持-上臂

×1

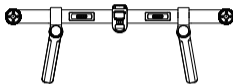

环形手持-下臂

×1



工型握把

×1



无线接收盒

×1



环形遥控手柄

×1

硅胶保护盖

×2

认识DJI RONIN环形手持控制套装

适配DJI RS 2/RS 3 PRO/RS 4/RS 4 PRO云台

- 01 供电手柄接驳件
- 02 供电接口
- 03 环形手持-上臂
- 04 旋钮
- 05 环形遥控手柄
- 06 无线接收盒
- 07 云台安装底座
- 08 脚架开关
- 09 脚架
- 10 供电手柄锁紧旋钮
- 11 冷靴槽
- 12 输出供电(选配)
- 13 工型握把
- 14 环形手持-下臂
- 15 V口供电底座(选配)

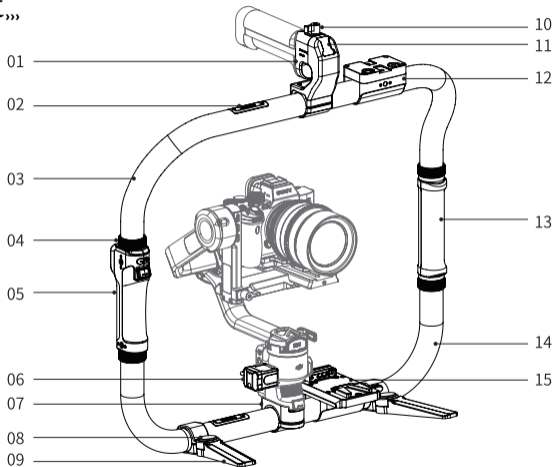

认识遥控手柄

- 01 1/4定位螺纹孔
- 02 摇杆
- 03 1/4定位螺纹孔
- 04 指示灯
- 05 M键
- 06 相机控制键
- 07 1/4定位螺纹孔
- 08 1/4定位螺纹孔
- 09 硅胶保护盖
- 10 Type-C接口
- 11 扳机键

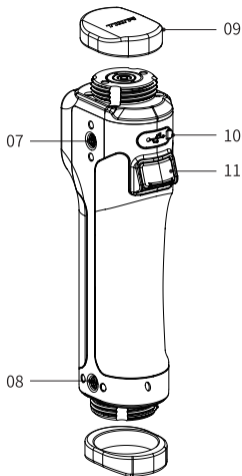
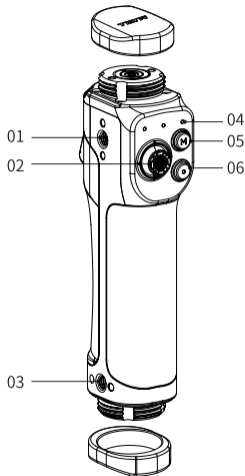

遥控手柄按键功能

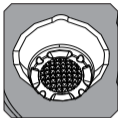

摇杆

上下摇动：控制俯仰轴运动

左右摇动：控制平移轴运动

校准方法：(1)连续按扳机键三下，第四下时长按，此时三个指示灯闪烁，再将摇杆上下左右各推一下，等待10秒，指示灯恢复正常即校准成功。

(2)校准不成功时，指示灯红灯亮起，重复上述操作退出摇杆校准，再重新校准。



M键

单击：切换云台模式，指示灯绿灯亮起，随模式切换。(三种模式：M1 全域跟随；M2 平移跟随；M3 双向跟随)

双击：竖拍模式，再次双击M键取消竖拍模式。

三击：进入360旋转模式，重复操作可退出。360旋转模式下，向左或向右连续摇动摇杆两次，可使相机自动旋转，双击扳机键可停止。

长按不放：进入运动模式，松开M键解除运动模式。

长按并双击扳机键：锁定运动模式(不需要保持长按不放)，重复操作可退出功能。

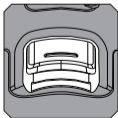

扳机Trigger键

单击：(安装图传系统并开启)开始智能跟随

双击：云台回中

三击：进入自拍模式

长按不放：进入锁定模式



相机控制按键

半按：控制自动对焦

短按：开始或停止录像

长按：拍照

安 装

(1) 按下圆形脚架开关, 分别向外侧打开脚架。

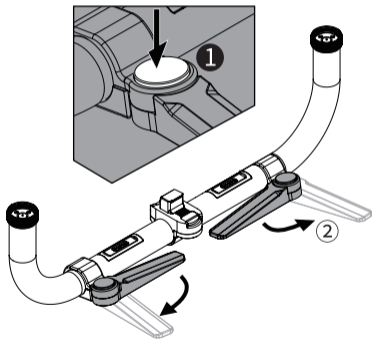

(2) 对准限位柱, 将两个手柄分别安装至环形手持-下臂的手柄接口上, 逆时针方向转动旋钮, 锁紧手柄。

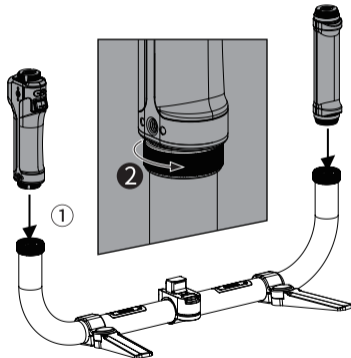

(3) 将环形手持-上臂安装至两个手柄的上方，顺时针方向转动旋钮锁紧。

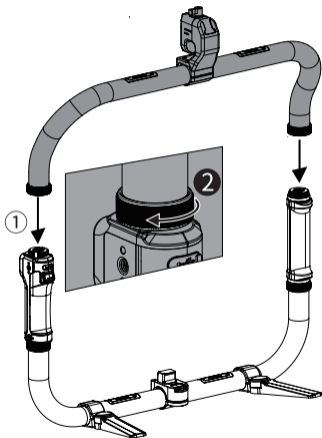

(4) 将DJI RS 2/RS 3 PRO/RS 4/RS 4 PRO安装至环形手持上。

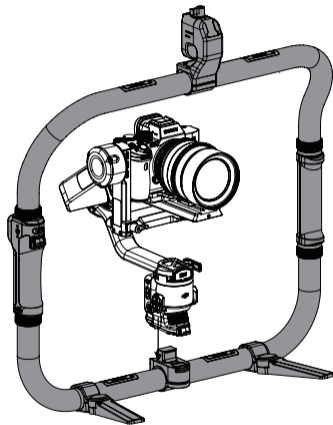

(5) 将无线接收盒安装至DJI RS 2/RS 3 PRO/RS 4/
RS 4 PRO右边的NATO接口上, 锁紧旋钮。

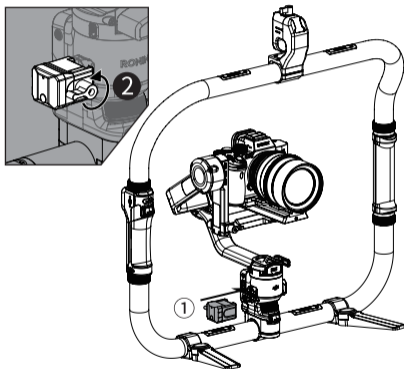

(6) 将DJI RS 2/RS 3 PRO/RS 4/RS 4 PRO电池手柄
安装进供电手柄接驳件中, 锁紧旋钮。

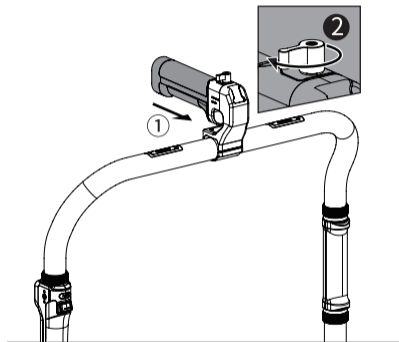

(7) 套装安装完成。环形手持通电后，安装好的遥控手柄和无线接收盒同步通电开机，指示灯绿灯亮起。

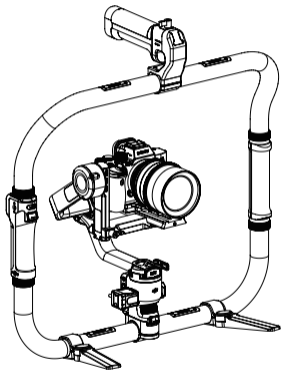

遥控手柄与无线接收盒配对

(1) 双击无线接收盒上的按键，指示灯红灯闪烁，等待遥控手柄与其配对。

(2) 在遥控手柄上同时按住【相机控制按键】和【M键】进入自动配对模式，指示灯循环跑动，当指示灯停止跑动绿灯亮起时，即配对成功。

如果红灯亮起，则配对失败，需要重新配对。

切换无线频道

在遥控手柄上同时按住【相机控制按键】和【扳机Trigger键】，指示灯闪烁，即无线频道已切换。

选 配

环形手持输出供电 (TGA-RG-PM)

将输出供电安装至上环臂供电口位置处，锁紧螺丝。

有预留冷靴口、1/4、3/8螺纹口，可以接蜗4云台，手机支架等配件。
有14.8VD-TAP供电和USB供电接口，可以给监视器和手机供电。

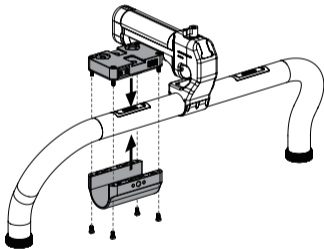

V口供电底座 (TGA-RG-V) /

安东口供电底座 (TGA-RG-AB)

将V口供电底座或安东口供电底座安装至上环臂供电口位置处，锁紧螺丝。可实现超续航不间断供电。

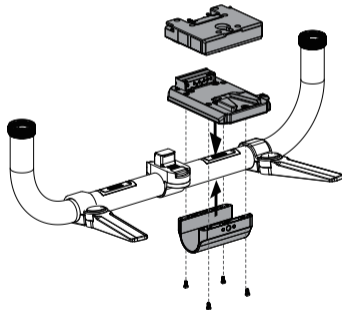

**BASIC RING GRIP PLUS
FOR DJI RONIN CONTROL KIT**