

FOR SONY FX2

TILTA

[铁头适用于索尼FX2全笼]

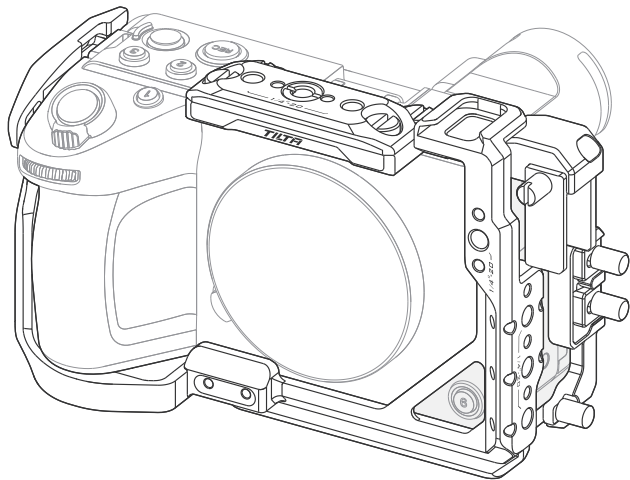

使用指南/User Guide

DISCLAIMER

Thank you for purchasing TILTA products.

Before using this product, please carefully read this document to ensure that the product has been set up correctly. The final interpretation of this document and all related documents for this product belongs to TILTA. For updates, please visit the official website at www.tilta.com for the latest product information.

TILTA reserves the right to modify any information in this manual at any time without prior notice and without assuming any responsibility.

By using this product, you are deemed to have carefully read the disclaimer and warnings, understood, agreed, and accepted all the terms and content of this statement. You promise to take full responsibility for the use of this product and any consequences that may arise. You commit to using this product only for legitimate purposes and agree to these terms as well as any related regulations, policies, and guidelines set by TILTA.

TILTA is not responsible for any damages, injuries, or legal liabilities caused directly or indirectly by the use of this product. Users should follow all safety guidelines mentioned in this document, including but not limited to those mentioned.

Despite the above provisions, consumer rights are still protected by local laws and regulations and are not affected by this disclaimer.

OVERVIEW

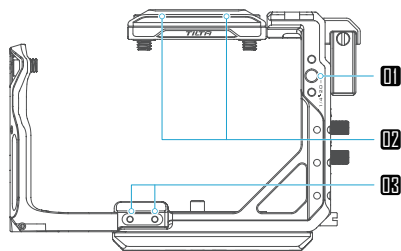

FRONT

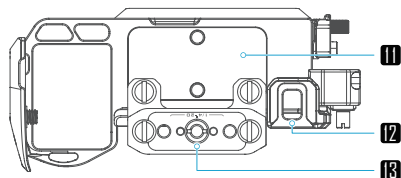

TOP

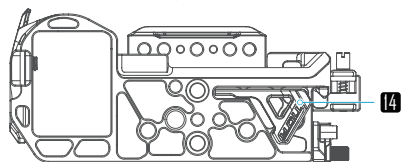

BOTTOM

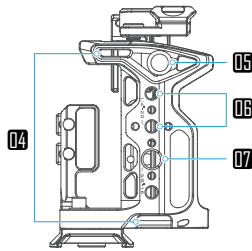

LEFT SIDE

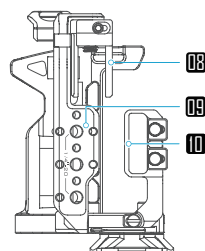

RIGHT SIDE

- 01 1/4"-20 Thread with Locating Points
- 02 NATO Rail (Top)
- 03 M3 Thread (For mounting lens adapter support)
- 04 Wrist Strap Port
- 05 Camera Mounting Point (Side)
- 06 1/4"-20 Thread with Locating Points
- 07 3/8"-16 Thread with Locating Points
- 08 HDMI Cable Clamp
- 09 NATO Rail (Side)
- 10 Cable Clamp (MULTI + USB-C)
- 11 Silicone Anti-Slip Pad
- 12 Cold Shoe Receiver
- 13 3/8"-16 to 1/4"-20 Thread Adapter
- 14 Magnetic Screwdriver
- 15 Arca-Swiss Bottom Plate

Product Specifications

SKU	DIMENSIONS	NET WEIGHT
TA-T88	159.4×74.3×109.6mm (6.28×2.93×4.32 in)	250g (8.82 oz)

ASSEMBLING THE FULL CAGE

01

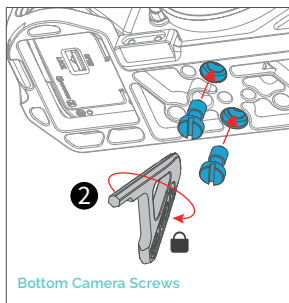
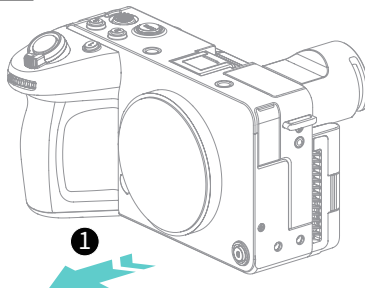
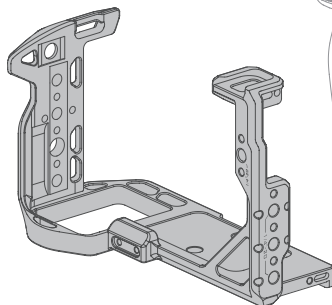

Bottom Camera Screws

Left Side Camera Screw

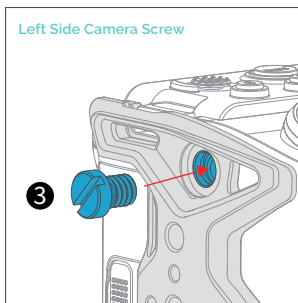

💡 To install the NATO rail, attach it to the top of the camera cage to provide mounting space for a top handle. If you need to install the original top handle, simply remove the NATO rail from the camera cage.

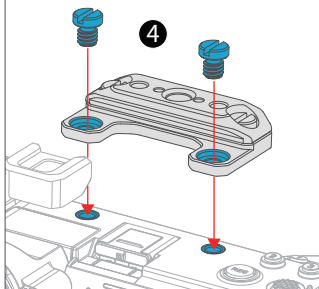

INSTALLING THE CABLE CLAMP AND THE BOTTOM PLATE

02

Vertical Mode

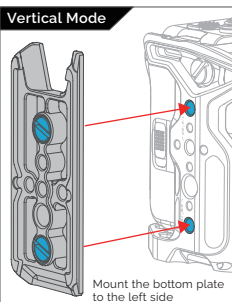

Horizontal Mode

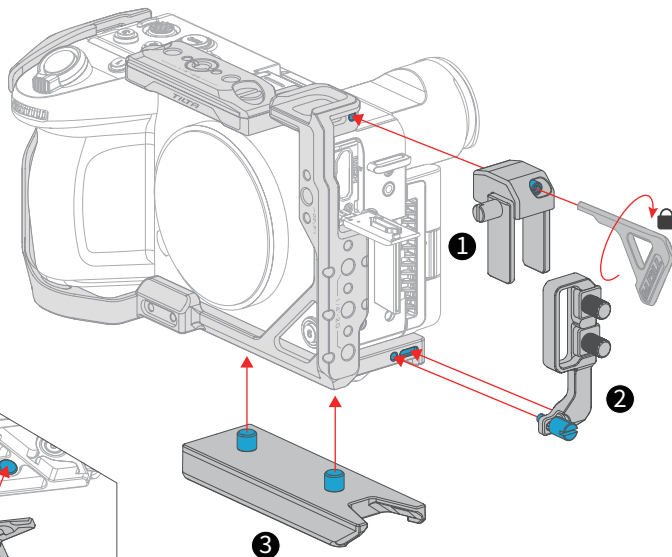
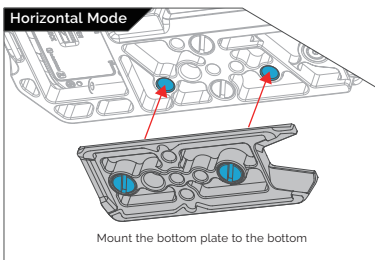

免责声明

感谢您购买TILTA产品。

使用本产品之前,请仔细阅读本文以确保已对产品进行正确的设置。本文档及本产品所有相关的文档最终解释权归TILTA所有。如有更新,请访问www.tilta.com官方网站获取最新的产品信息。TILTA保留随时修改本手册中任何信息的权利,无需提前通知且不承担任何责任。

一旦使用本产品,即视为您已经仔细阅读免责声明与警告,理解、认可和接受本声明全部条款和内容。您承诺对使用本产品以及可能带来的后果负全部责任。

您承诺仅出于正当目的使用本产品,并且同意本条款以及TILTA制定的任何相关条例、政策和指引。TILTA对于直接或间接使用本产品而造成的损坏、伤害以及任何法律责任不予负责。用户应遵循包括但不限于本文提及的所有安全指引。

即使存在上述规定,消费者权益依然受当地法律法规所保障,并不受本免责声明影响。

TILTA是深圳市铁头科技有限公司及其关联公司的商标。本文出现的产品名称、品牌等均为其所属公司的商标或注册商标。

认识全笼

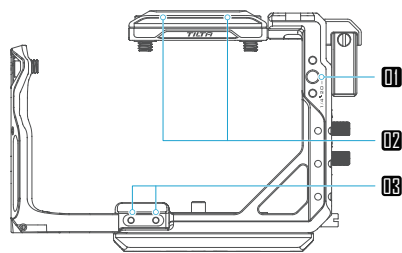

正面

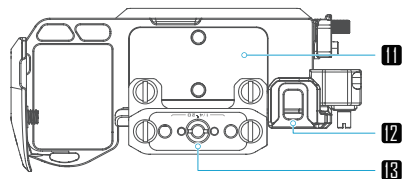

顶部

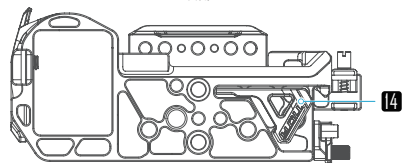

底部

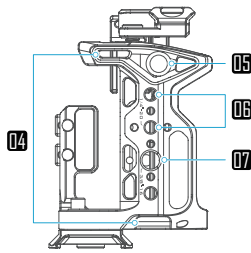
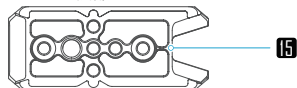

左侧臂

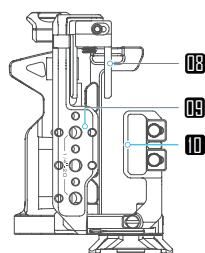

右侧臂

- 01 1/4定位螺纹孔
- 02 NATO滑条 (顶板)
- 03 M3安装孔
[可安装镜头转接环支撑]
- 04 腕带接口
- 05 机身固定孔(侧臂)
- 06 1/4定位螺纹孔
- 07 3/8定位螺纹孔
- 08 HDMI线夹

- 09 NATO滑条 (侧臂)
- 10 线夹 (MULTI + TYPE-C)
- 11 硅胶防滑垫
- 12 冷靴接口
- 13 3/8转1/4螺套
- 14 双规格磁吸扳手
- 15 阿卡底板

产品参数

产品类型号	产品尺寸	净 重
TA-T88	159.4×74.3×109.6mm	250g

安装全笼

01

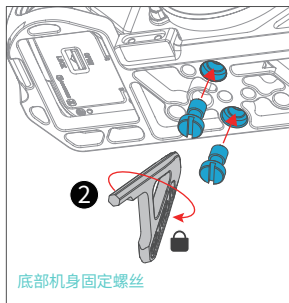
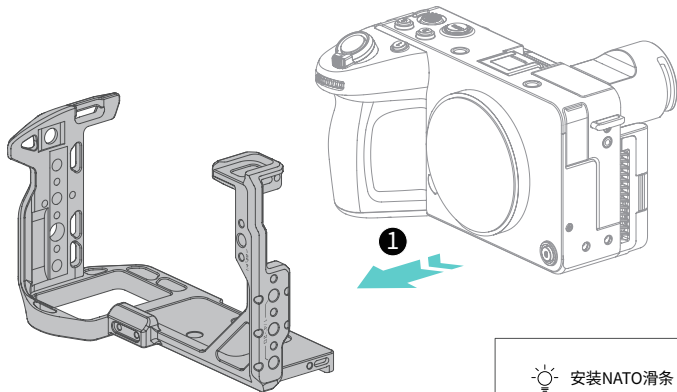

底部机身固定螺丝

左侧机身固定螺丝

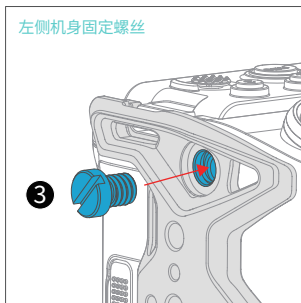

💡 安装NATO滑条 (顶板), 可外接上手提等配件。拆卸后可安装原装上手提。

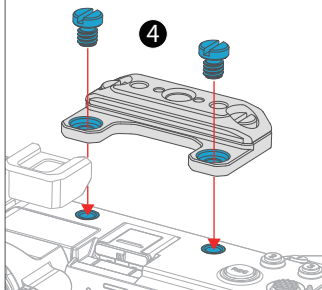

安装线夹与底板

02

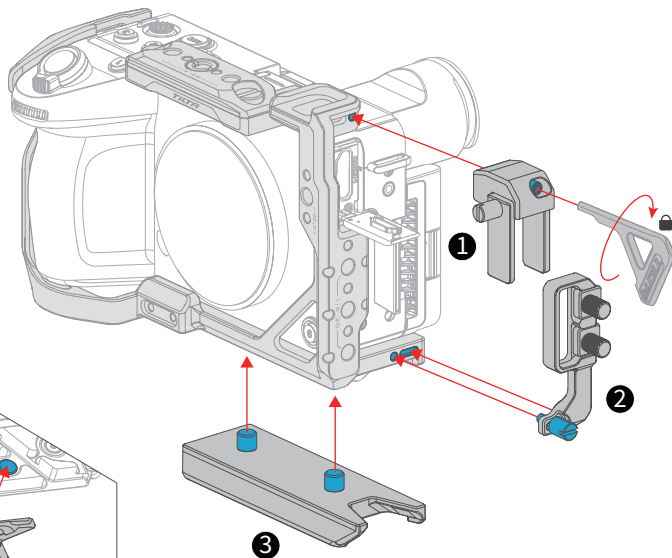
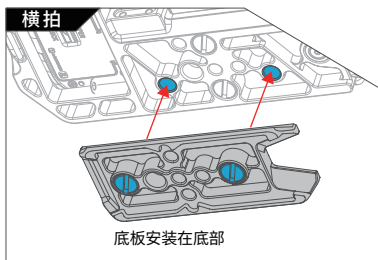
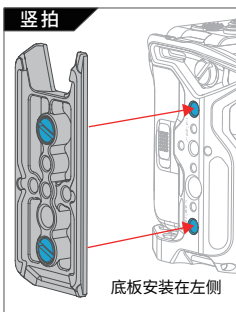



FOR SONY FX2 FULL CAMERA CAGE

制 造 商：深圳市铁头科技有限公司

地 址：深圳市光明区玉塘街道田寮社区光明高新园西区七号侨德科技园厂房B栋一层、二层

服务热线：4006 1998 67

Manufacturer : Shenzhen Tilta Technology Co. Ltd.

Address (China) : 1st and 2nd Floor, Building B, Qiaode High Technology Park, No.7 Road, Guangming New Dist, Shenzhen, 518125

Address (United States) : 1901 W Magnolia Blvd, Burbank, CA 91506

Address (Germany) : Lise-Meitner-Allee 13, Bochum, North Rhine-Westphalia 44801

Address (United kingdom) : Room 3, Unit 11, Woodland Business Park, Ystradgynlais, Swansea SA9 1JW

Official website : <https://tilta.com/>
<https://eu.tilta.com/>
<https://tilta.uk/>